

RAIN WATER HARVESTING TANK,
CAP=300CM (5MOES) MAX (900 DEPTH),
CONSIDERING PB=750MM
SCALE: 1:50

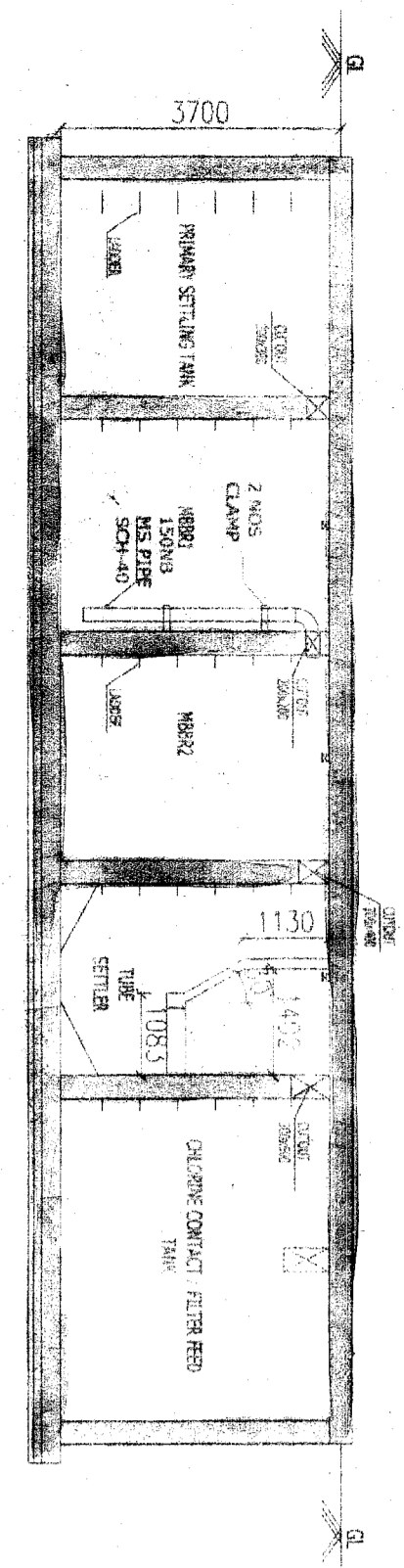

SECTION DD
SCALE: 1:50

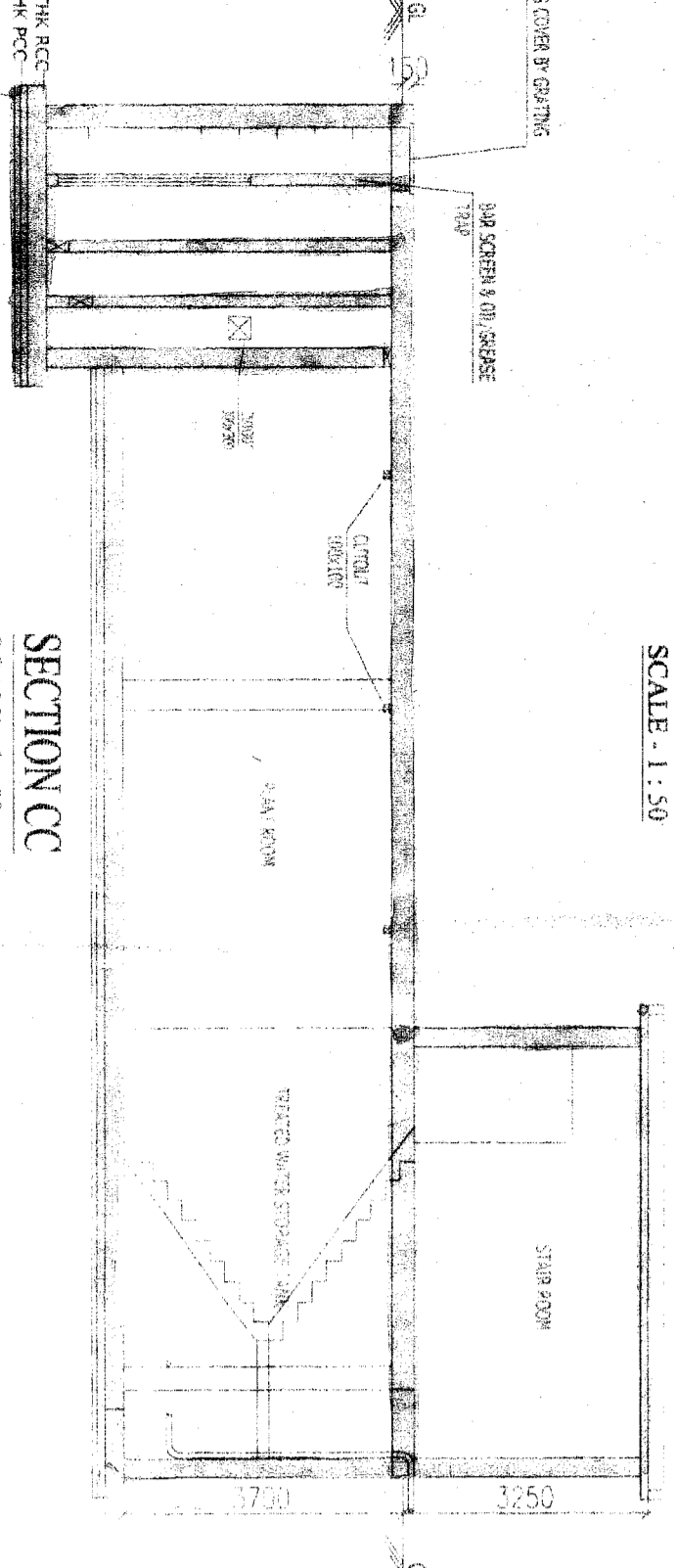

SECTION CC
SCALE: 1:50

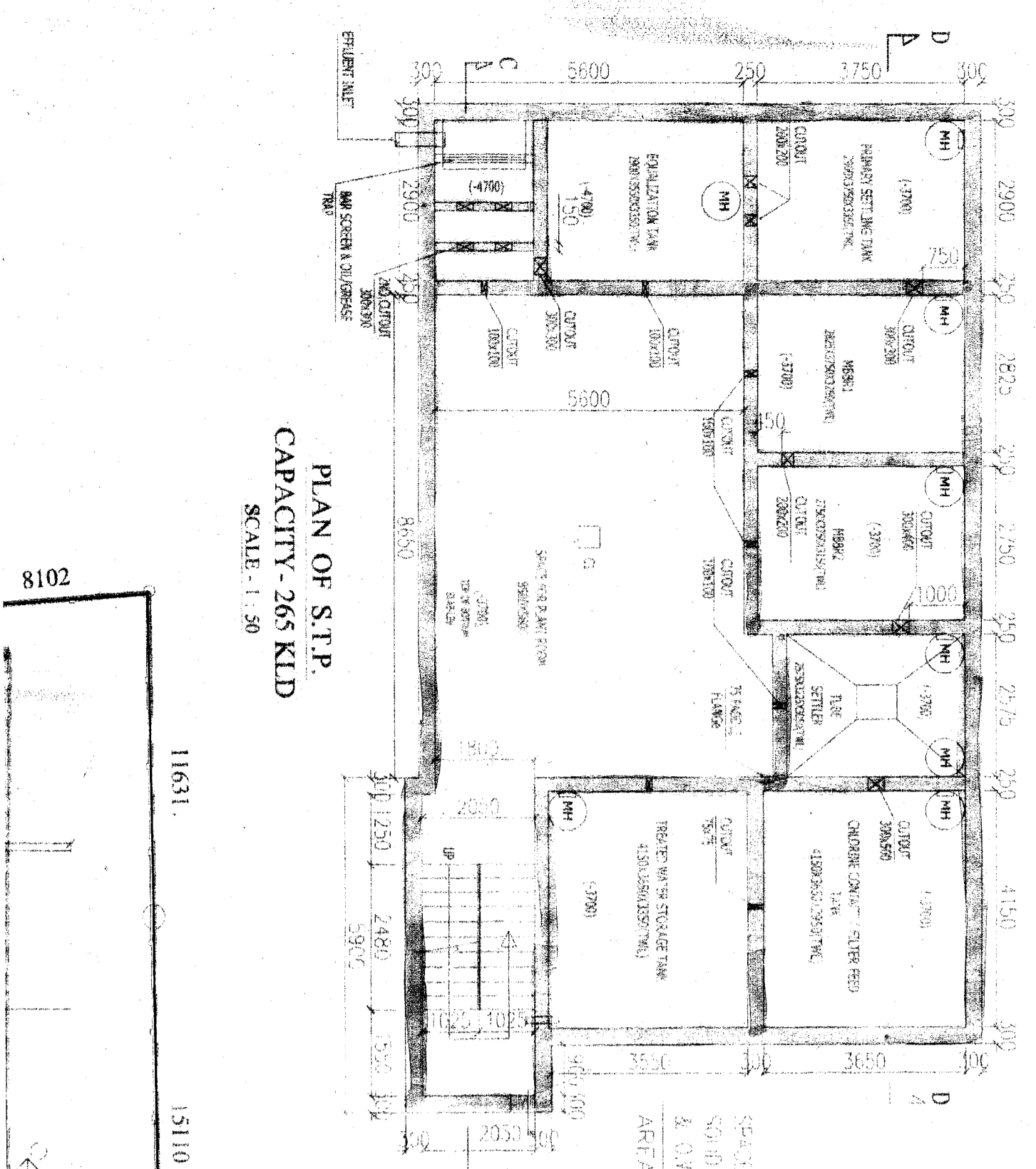

PLAN OF ST.P
CAPACITY=206 KLD
SCALE: 1:50

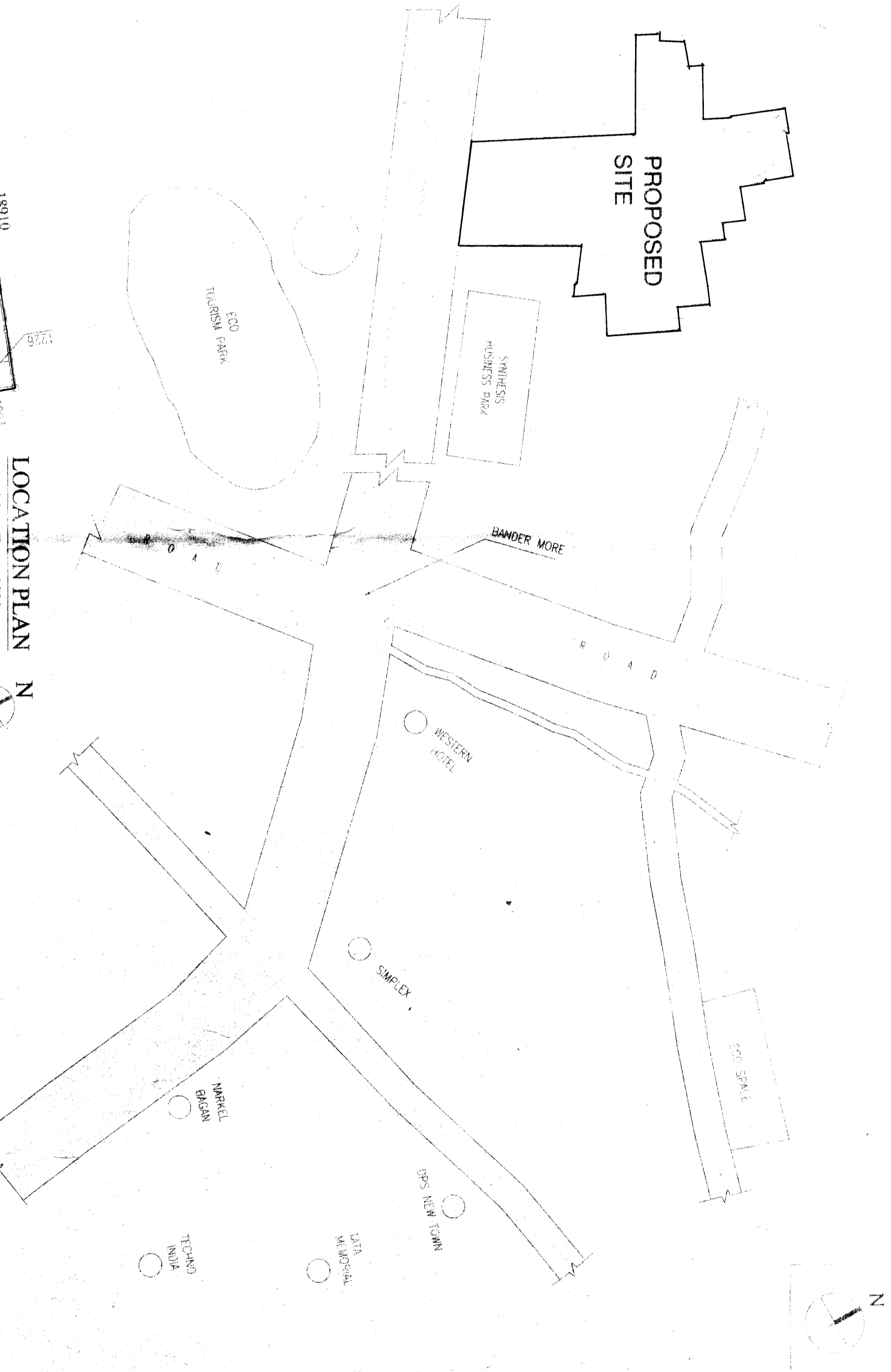

LOCATION PLAN
SCALE: 1:1000

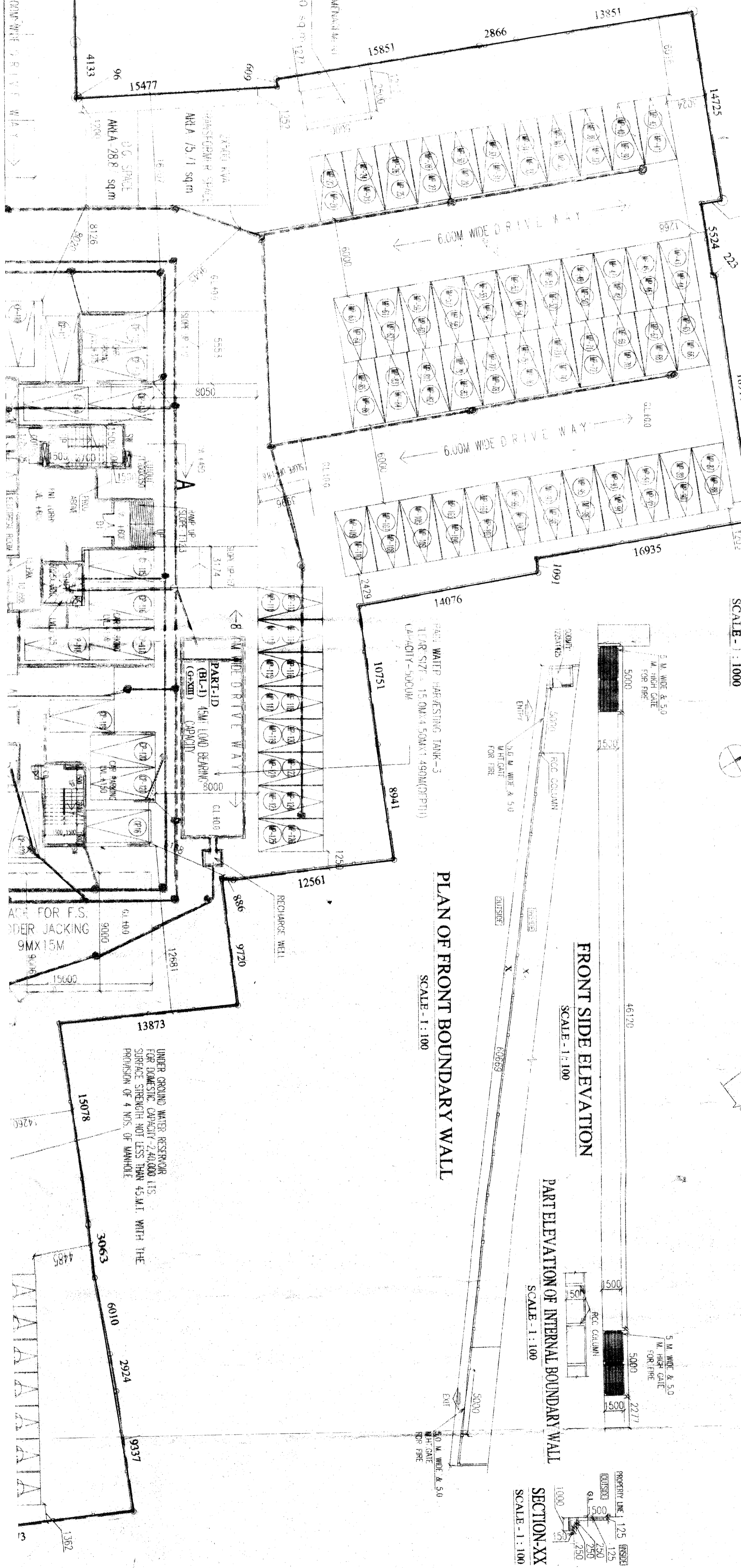

PLAN OF FRONT BOUNDARY WALL
SCALE: 1:100

FRONT SIDE ELEVATION
SCALE: 1:100

PART ELEVATION OF INTERNAL BOUNDARY WALL
SCALE: 1:100

SECTION XX
SCALE: 1:100

AREA STATEMENT

1. AREA OF LAND AS PER VIDEO	= 1644.02 SQ.M
2. AREA OF LAND AS PER SURVEY	= 1644.02 SQ.M
3. AREA OF LAND AS PER PHYSICAL MEASUREMENT	= 1644.02 SQ.M
4. AREA OF LAND AS PER PHOTO SURVEY	= 1644.02 SQ.M
5. AREA OF LAND AS PER AERIAL PHOTO SURVEY	= 1644.02 SQ.M
6. AREA OF LAND AS PER GPS SURVEY	= 1644.02 SQ.M
7. AREA OF LAND AS PER TOTAL STATION SURVEY	= 1644.02 SQ.M
8. AREA OF LAND AS PER TOTAL STATION SURVEY	= 1644.02 SQ.M
9. AREA OF LAND AS PER TOTAL STATION SURVEY	= 1644.02 SQ.M
10. AREA OF LAND AS PER TOTAL STATION SURVEY	= 1644.02 SQ.M
11. AREA OF LAND AS PER TOTAL STATION SURVEY	= 1644.02 SQ.M
12. AREA OF LAND AS PER TOTAL STATION SURVEY	= 1644.02 SQ.M
13. AREA OF LAND AS PER TOTAL STATION SURVEY	= 1644.02 SQ.M
14. AREA OF LAND AS PER TOTAL STATION SURVEY	= 1644.02 SQ.M
15. AREA OF LAND AS PER TOTAL STATION SURVEY	= 1644.02 SQ.M
16. AREA OF LAND AS PER TOTAL STATION SURVEY	= 1644.02 SQ.M
17. AREA OF LAND AS PER TOTAL STATION SURVEY	= 1644.02 SQ.M
18. AREA OF LAND AS PER TOTAL STATION SURVEY	= 1644.02 SQ.M
19. AREA OF LAND AS PER TOTAL STATION SURVEY	= 1644.02 SQ.M
20. AREA OF LAND AS PER TOTAL STATION SURVEY	= 1644.02 SQ.M
21. AREA OF LAND AS PER TOTAL STATION SURVEY	= 1644.02 SQ.M
22. AREA OF LAND AS PER TOTAL STATION SURVEY	= 1644.02 SQ.M
23. AREA OF LAND AS PER TOTAL STATION SURVEY	= 1644.02 SQ.M
24. AREA OF LAND AS PER TOTAL STATION SURVEY	= 1644.02 SQ.M
25. AREA OF LAND AS PER TOTAL STATION SURVEY	= 1644.02 SQ.M
26. AREA OF LAND AS PER TOTAL STATION SURVEY	= 1644.02 SQ.M
27. AREA OF LAND AS PER TOTAL STATION SURVEY	= 1644.02 SQ.M
28. AREA OF LAND AS PER TOTAL STATION SURVEY	= 1644.02 SQ.M
29. AREA OF LAND AS PER TOTAL STATION SURVEY	= 1644.02 SQ.M
30. AREA OF LAND AS PER TOTAL STATION SURVEY	= 1644.02 SQ.M
31. AREA OF LAND AS PER TOTAL STATION SURVEY	= 1644.02 SQ.M
32. AREA OF LAND AS PER TOTAL STATION SURVEY	= 1644.02 SQ.M
33. AREA OF LAND AS PER TOTAL STATION SURVEY	= 1644.02 SQ.M
34. AREA OF LAND AS PER TOTAL STATION SURVEY	= 1644.02 SQ.M
35. AREA OF LAND AS PER TOTAL STATION SURVEY	= 1644.02 SQ.M
36. AREA OF LAND AS PER TOTAL STATION SURVEY	= 1644.02 SQ.M
37. AREA OF LAND AS PER TOTAL STATION SURVEY	= 1644.02 SQ.M
38. AREA OF LAND AS PER TOTAL STATION SURVEY	= 1644.02 SQ.M
39. AREA OF LAND AS PER TOTAL STATION SURVEY	= 1644.02 SQ.M
40. AREA OF LAND AS PER TOTAL STATION SURVEY	= 1644.02 SQ.M
41. AREA OF LAND AS PER TOTAL STATION SURVEY	= 1644.02 SQ.M
42. AREA OF LAND AS PER TOTAL STATION SURVEY	= 1644.02 SQ.M
43. AREA OF LAND AS PER TOTAL STATION SURVEY	= 1644.02 SQ.M
44. AREA OF LAND AS PER TOTAL STATION SURVEY	= 1644.02 SQ.M
45. AREA OF LAND AS PER TOTAL STATION SURVEY	= 1644.02 SQ.M
46. AREA OF LAND AS PER TOTAL STATION SURVEY	= 1644.02 SQ.M
47. AREA OF LAND AS PER TOTAL STATION SURVEY	= 1644.02 SQ.M
48. AREA OF LAND AS PER TOTAL STATION SURVEY	= 1644.02 SQ.M
49. AREA OF LAND AS PER TOTAL STATION SURVEY	= 1644.02 SQ.M
50. AREA OF LAND AS PER TOTAL STATION SURVEY	= 1644.02 SQ.M
51. AREA OF LAND AS PER TOTAL STATION SURVEY	= 1644.02 SQ.M
52. AREA OF LAND AS PER TOTAL STATION SURVEY	= 1644.02 SQ.M
53. AREA OF LAND AS PER TOTAL STATION SURVEY	= 1644.02 SQ.M
54. AREA OF LAND AS PER TOTAL STATION SURVEY	= 1644.02 SQ.M
55. AREA OF LAND AS PER TOTAL STATION SURVEY	= 1644.02 SQ.M
56. AREA OF LAND AS PER TOTAL STATION SURVEY	= 1644.02 SQ.M
57. AREA OF LAND AS PER TOTAL STATION SURVEY	= 1644.02 SQ.M
58. AREA OF LAND AS PER TOTAL STATION SURVEY	= 1644.02 SQ.M
59. AREA OF LAND AS PER TOTAL STATION SURVEY	= 1644.02 SQ.M
60. AREA OF LAND AS PER TOTAL STATION SURVEY	= 1644.02 SQ.M
61. AREA OF LAND AS PER TOTAL STATION SURVEY	= 1644.02 SQ.M
62. AREA OF LAND AS PER TOTAL STATION SURVEY	= 1644.02 SQ.M
63. AREA OF LAND AS PER TOTAL STATION SURVEY	= 1644.02 SQ.M
64. AREA OF LAND AS PER TOTAL STATION SURVEY	= 1644.02 SQ.M
65. AREA OF LAND AS PER TOTAL STATION SURVEY	= 1644.02 SQ.M
66. AREA OF LAND AS PER TOTAL STATION SURVEY	= 1644.02 SQ.M
67. AREA OF LAND AS PER TOTAL STATION SURVEY	= 1644.02 SQ.M
68. AREA OF LAND AS PER TOTAL STATION SURVEY	= 1644.02 SQ.M
69. AREA OF LAND AS PER TOTAL STATION SURVEY	= 1644.02 SQ.M
70. AREA OF LAND AS PER TOTAL STATION SURVEY	= 1644.02 SQ.M
71. AREA OF LAND AS PER TOTAL STATION SURVEY	= 1644.02 SQ.M
72. AREA OF LAND AS PER TOTAL STATION SURVEY	= 1644.02 SQ.M
73. AREA OF LAND AS PER TOTAL STATION SURVEY	= 1644.02 SQ.M
74. AREA OF LAND AS PER TOTAL STATION SURVEY	= 1644.02 SQ.M
75. AREA OF LAND AS PER TOTAL STATION SURVEY	= 1644.02 SQ.M
76. AREA OF LAND AS PER TOTAL STATION SURVEY	= 1644.02 SQ.M
77. AREA OF LAND AS PER TOTAL STATION SURVEY	= 1644.02 SQ.M
78. AREA OF LAND AS PER TOTAL STATION SURVEY	= 1644.02 SQ.M
79. AREA OF LAND AS PER TOTAL STATION SURVEY	= 1644.02 SQ.M
80. AREA OF LAND AS PER TOTAL STATION SURVEY	= 1644.02 SQ.M
81. AREA OF LAND AS PER TOTAL STATION SURVEY	= 1644.02 SQ.M
82. AREA OF LAND AS PER TOTAL STATION SURVEY	= 1644.02 SQ.M
83. AREA OF LAND AS PER TOTAL STATION SURVEY	= 1644.02 SQ.M
84. AREA OF LAND AS PER TOTAL STATION SURVEY	= 1644.02 SQ.M
85. AREA OF LAND AS PER TOTAL STATION SURVEY	= 1644.02 SQ.M
86. AREA OF LAND AS PER TOTAL STATION SURVEY	= 1644.02 SQ.M
87. AREA OF LAND AS PER TOTAL STATION SURVEY	= 1644.02 SQ.M
88. AREA OF LAND AS PER TOTAL STATION SURVEY	= 1644.02 SQ.M
89. AREA OF LAND AS PER TOTAL STATION SURVEY	= 1644.02 SQ.M
90. AREA OF LAND AS PER TOTAL STATION SURVEY	= 1644.02 SQ.M
91. AREA OF LAND AS PER TOTAL STATION SURVEY	= 1644.02 SQ.M
92. AREA OF LAND AS PER TOTAL STATION SURVEY	= 1644.02 SQ.M
93. AREA OF LAND AS PER TOTAL STATION SURVEY	= 1644.02 SQ.M
94. AREA OF LAND AS PER TOTAL STATION SURVEY	= 1644.02 SQ.M
95. AREA OF LAND AS PER TOTAL STATION SURVEY	= 1644.02 SQ.M
96. AREA OF LAND AS PER TOTAL STATION SURVEY	= 1644.02 SQ.M
97. AREA OF LAND AS PER TOTAL STATION SURVEY	= 1644.02 SQ.M
98. AREA OF LAND AS PER TOTAL STATION SURVEY	= 1644.02 SQ.M
99. AREA OF LAND AS PER TOTAL STATION SURVEY	= 1644.02 SQ.M
100. AREA OF LAND AS PER TOTAL STATION SURVEY	= 1644.02 SQ.M

14. COVERED AREA OF ALL PARTS

GROUND FLOOR	INCL. CAR PARKING & EXCL. SHAWT AREA & STAIR
BLOCK-1	
PART-1A	574.69 SQ.M
PART-1B	556.87 SQ.M
PART-1C	636.48 SQ.M
PART-1D	652.71 SQ.M
BELOW ROOM & CONNECTING PART	182.71 SQ.M
CLUB	487.48 SQ.M
TOTAL	2954.94 SQ.M
FIRST FLOOR	(EXCL. LIFT WELL, SERVICE DUCT, SHAWT STAIR)
BLOCK-1	
PART-1A	629.34 SQ.M
PART-1B	520.48 SQ.M
PART-1C	534.80 SQ.M
PART-1D	518.92 SQ.M
CLUB	652.93 SQ.M
TOTAL	2859.47 SQ.M
TYPICAL FLOOR (FROM TO 12TH)	
(EXCL. LIFT WELL, SERVICE DUCT, SHAWT STAIR)	
BLOCK-1	
PART-1A (629.34 SQ.M X 12 FL.)	= 7552.08 SQ.M
PART-1B (520.48 SQ.M X 12 FL.)	= 6245.76 SQ.M
PART-1C (534.80 SQ.M X 12 FL.)	= 6417.60 SQ.M
PART-1D (518.92 SQ.M X 12 FL.)	= 6227.04 SQ.M
CLUB (652.93 SQ.M X 12 FL.)	= 7835.16 SQ.M
TOTAL	34377.64 SQ.M
TYPICAL FLOOR (FROM TO 12TH)	
(EXCL. LIFT WELL, SERVICE DUCT, SHAWT STAIR)	
BLOCK-1	
PART-1A (629.34 SQ.M X 12 FL.)	= 7552.08 SQ.M
PART-1B (520.48 SQ.M X 12 FL.)	= 6245.76 SQ.M
PART-1C (534.80 SQ.M X 12 FL.)	= 6417.60 SQ.M
PART-1D (518.92 SQ.M X 12 FL.)	= 6227.04 SQ.M
CLUB (652.93 SQ.M X 12 FL.)	= 7835.16 SQ.M
TOTAL	34377.64 SQ.M

15. TOTAL COVERED AREA (BLOCK-1) = 41821.03 SQ.M
 (EXCL. LIFT WELL, SERVICE DUCT, SHAWT STAIR)

16. TOTAL EXPOSED AREA FOR F.A.B. CALCULATION (A+B+C+D)
 a) TOTAL CAR PARKING AREA = 4062.36 SQ.M
 b) TOTAL CAR PARKING AREA = 4062.36 SQ.M
 c) TOTAL CAR PARKING AREA = 4062.36 SQ.M
 d) TOTAL CAR PARKING AREA = 4062.36 SQ.M

17. TOTAL COVERED AREA (BLOCK-1)
 a) TOTAL COVERED AREA = 41821.03 SQ.M
 b) TOTAL COVERED AREA = 41821.03 SQ.M
 c) TOTAL COVERED AREA = 41821.03 SQ.M
 d) TOTAL COVERED AREA = 41821.03 SQ.M

18. PROPOSED F.A.B. = 224
 19. TOTAL C.A. AREA = 610.48 SQ.M
 20. GATE QUANTITY AREA = 2.97 SQ.M
 21. ST.P. STAIR AREA = 13.97 SQ.M
 22. FIRE FIGHTER ROOM AREA = 9.04 SQ.M
 23. FIRE FIGHTER ROOM AREA = 9.04 SQ.M